

For Additional Information:  
 Ken Jansen  
 Cooper Patterson  
 913-777-6365

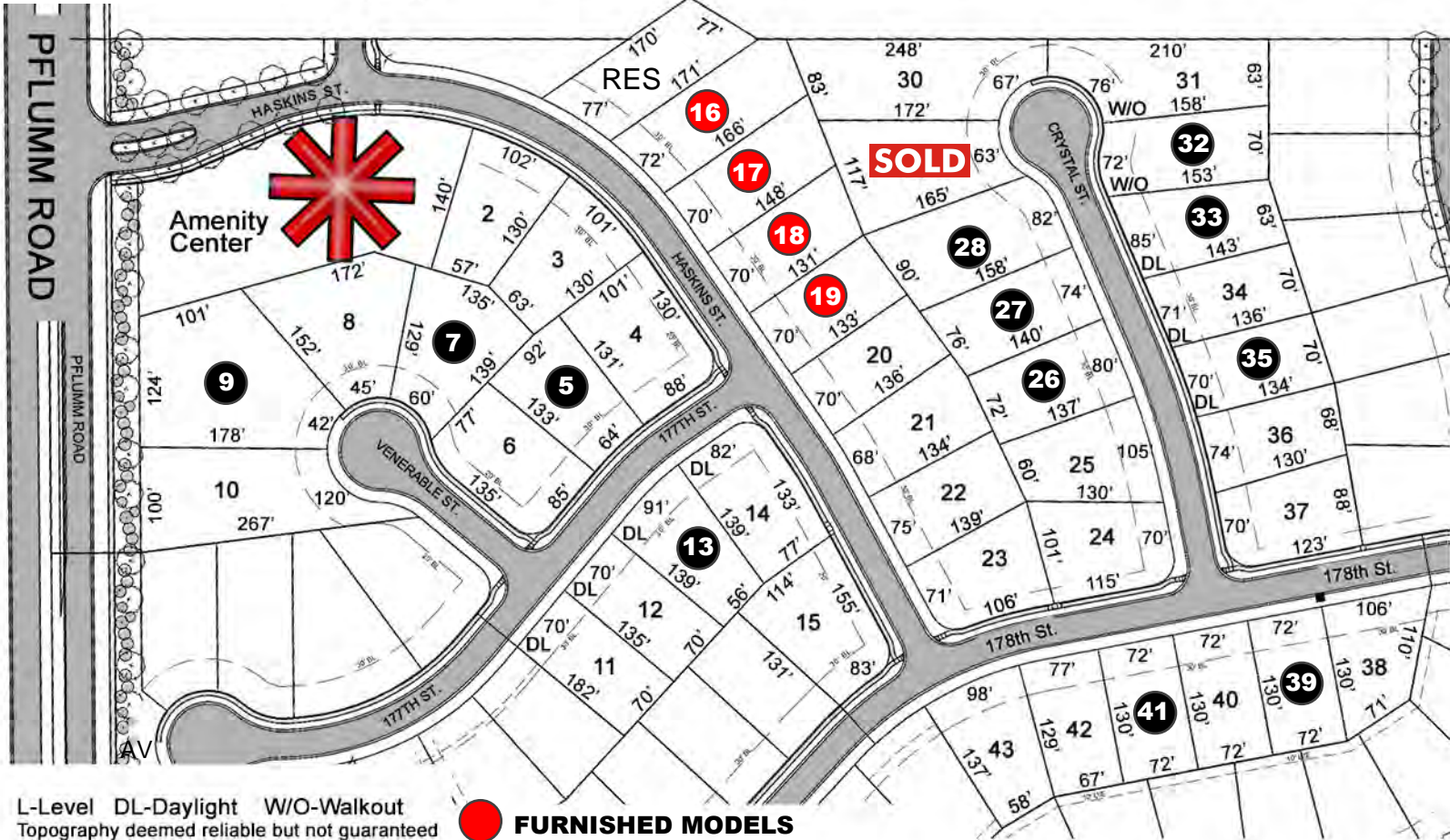

# WOLF RUN

177th & Pflumm  
 Overland Park, KS



L-Level DL-Daylight W/O-Walkout  
 Topography deemed reliable but not guaranteed  
 Prices subject to change without notice

**FURNISHED MODELS**

16- "Makenna" by Gabriel Homes  
 17- "Modello" by Pauli Homes  
 18- "Timberline" by Calyn Homes  
 19- "Aspen" by Crestwood Custom Homes

### AVAILABLE LOTS

| Lot | Topo  | Price   | Lot | Topo  | Price  | Lot | Topo  | Price   | Lot | Topo  | Price  |
|-----|-------|---------|-----|-------|--------|-----|-------|---------|-----|-------|--------|
| 2   | Level | 94,950  | 12  | D/L   | 99,950 | 24  | Level | 87,950  | 38  | Level | 89,950 |
| 3   | Level | 94,950  | 14  | D/L   | 89,950 | 25  | Level | 99,950  | 40  | Level | 87,950 |
| 4   | Level | 84,950  | 15  | Level | 84,950 | 30  | Level | 107,950 | 42  | Level | 87,950 |
| 6   | Level | 89,950  | 20  | Level | 89,950 | 31  | W/O   | 114,950 | 43  | Level | 91,950 |
| 8   | Level | 104,950 | 21  | Level | 89,950 | 34  | D/L   | 102,950 | 44  | Level | RES    |
| 10  | Level | 109,950 | 22  | Level | 89,950 | 36  | Level | 97,950  |     |       |        |
| 11  | D/L   | 99,950  | 23  | Level | 84,950 | 37  | Level | 87,950  |     |       |        |

### SPEC HOMES FOR SALE

| Lot           | Plan                 | Builder                | Address                      | Style            | Bed/Bath                    | Topo             | Price            | Completion      |
|---------------|----------------------|------------------------|------------------------------|------------------|-----------------------------|------------------|------------------|-----------------|
| 5             | "Makenna"            | Gabriel Homes          | 13404 W. 177th St.           | 2-Sty            | 4 Bed 3-1/2 Bath            | Level            | \$517,675        | 120+            |
| 7             | "Makenna"            | Gabriel Homes          | 17605 Venerable St.          | 2-Sty            | 4 Bed 3-1/2 Bath            | Level            | \$536,875        | 120+            |
| 9             | "Modello"            | Pauli Homes            | 17600 Venerable St.          | 2-Sty            | 4 Bed 3-1/2 Bath            | Level            | "TBD"            | 120+            |
| 13            | "Cheyenne"           | Crestwood              | 13405 W. 177th St.           | Rev 1-1/2        | 4 Bed 3 Bath                | D/L              | "TBD"            | 120+            |
| 26            | "Brookside"          | Crestwood              | 17700 Crystal St.            | 2-Sty            | 4 Bed 3-1/2 Bath            | Level            | "TBD"            | 120+            |
| 27            | "Timberline II"      | Calyn Homes            | 17652 Crystal St.            | 2-Sty            | 4 Bed 3-1/2 Bath            | Level            | "TBD"            | 120+            |
| 28            | "Aspen"              | Crestwood              | 17648 Crystal St.            | 2-Sty            | 5 Bed 4 Bath                | Level            | "TBD"            | 120+            |
| <del>29</del> | <del>"Modello"</del> | <del>Pauli Homes</del> | <del>17644 Crystal St.</del> | <del>2-Sty</del> | <del>4 Bed 3-1/2 Bath</del> | <del>Level</del> | <del>"TBD"</del> | <del>120+</del> |
| 32            | "Sicilian"           | Pauli Homes            | 17645 Crystal St.            | Rev 1-1/2        | 4 Bed 3-1/2 Bath            | W/O              | "TBD"            | 120+            |
| 33            | "Pine"               | Calyn Homes            | 17649 Crystal St.            | 2-Sty            | 4 Bed 3-1/2 Bath            | D/L              | "TBD"            | 120+            |
| 35            | "Makenna"            | Gabriel Homes          | 17705 Crystal St.            | 2-Sty            | 4 Bed 3-1/2 Bath            | D/L              | \$544,450        | 120+            |
| 39            | "Tahoe"              | Calyn Homes            | 13309 W. 178th St.           | 2-Sty            | 4 Bed 3-1/2 Bath            | Level            | "TBD"            | 120+            |
| 41            | "Makenna"            | Gabriel Homes          | 13353 W. 178th St.           | 2-Sty            | 4 Bed 3-1/2 Bath            | Level            | \$511,310        | 120+            |