



**INTRODUCING OVERLAND PARK'S  
NEWEST COMMUNITY**

*Home's From The \$400's*

*4 Furnished Models*

177th & Pflumm

[www.WolfRunKS.com](http://www.WolfRunKS.com)

913-777-6365



# WOLF RUN

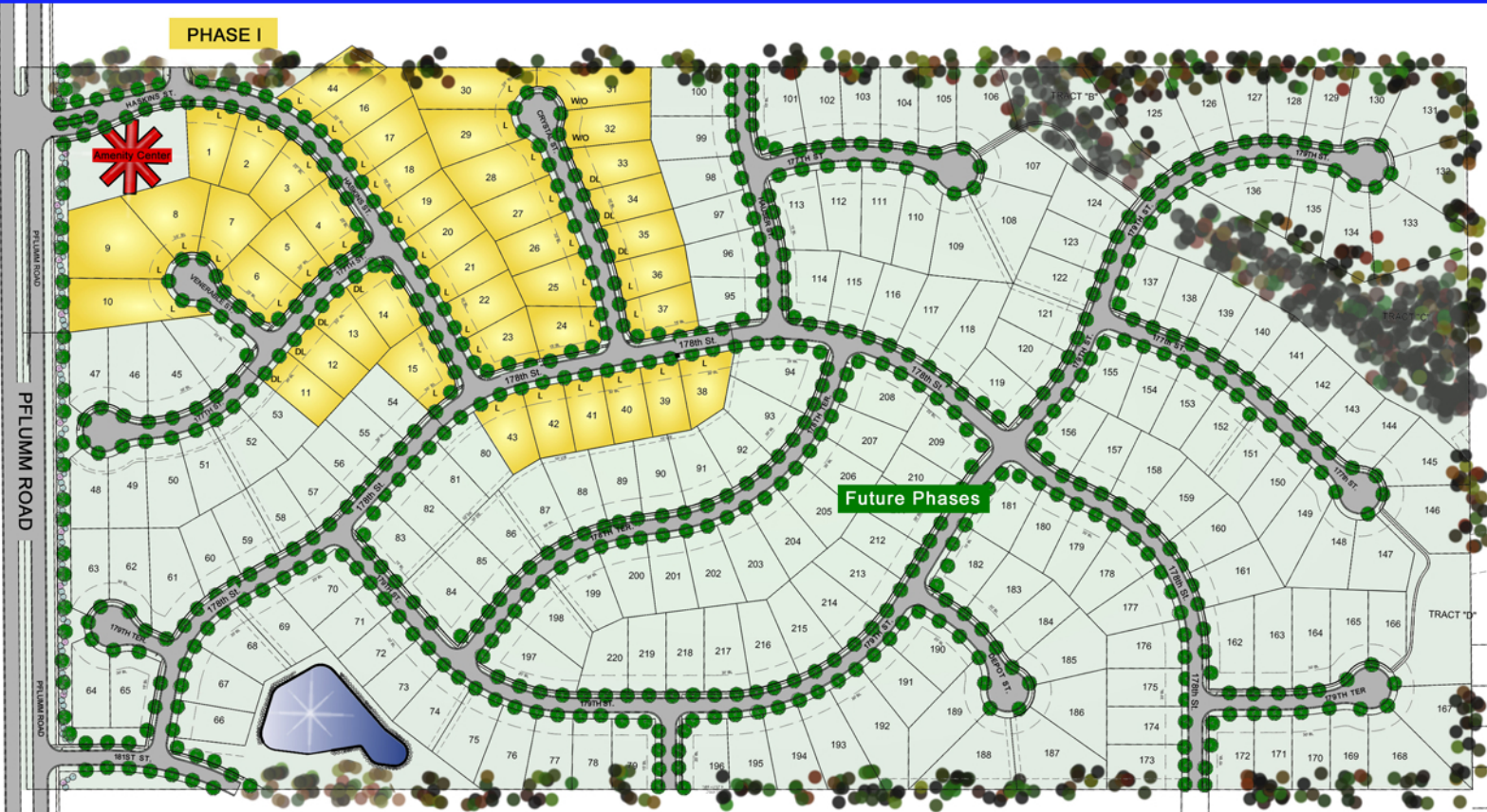

 **PRIME** DEVELOPMENT **WolfRunKS.com** **913-777-6365**

Welcome to Wolf Run! Perched on prime acreage at 117th St. and Pflumm, Wolf Run offers a rare combination: the appeal of an Overland Park address paired with access to Spring Hill Schools, a welcoming district in which students thrive inside the classroom and out.



## NEARBY AMENITIES



**Golfing**



**Dog Park**



**Heritage Park**



**Overland Park Arboretum**



## EXCEPTIONAL QUALITY OF LIFE

With close access to some of Overland Park's most beloved attractions, Wolf Run also offers homeowners a quiet retreat. Kids have room to run and play while parents catch up with neighbors. This warm, welcoming atmosphere is an ideal location to make memories that will last a lifetime.



# Outstanding Building Team



4 Furnished Models  
Coming Soon



GABRIELHOMES, INC.

**"Makenna"**  
4 Bedroom  
3-1/2 Bath



*building for higher expectations*

**"Modello"**  
4 Bedroom  
4-1/2 Bath



**"Timberline"**  
4 Bedroom  
3-1/2 Bath



**"Aspen"**  
5 Bedroom  
4 Bath



Conveniently  
located

177th & Pflumm



Wolf Run's prime location allows homeowners to be within minutes of shopping, dining, and services throughout Overland Park and the surrounding area.

*A remarkable new home community that combines several of Kansas City's best homebuilders, an inviting selection of amenities, attractive pricing and a coveted southern Overland Park address.*

*It's time to explore what's possible, and it all starts at Wolf Run.*



**(913) 777-6365**

**WolfRunKS.com**